



The Great Grid Upgrade

Sea Link

Sea Link

Volume 9: Examination Submissions

Document 9.76.5.8: Change Request Appendix H Tree Constraints Plans Suffolk Onshore Scheme

Planning Inspectorate Reference: EN20026

Version: A
November 2025

nationalgrid

Page intentionally blank

Contents

- Tree Plans Suffolk Site (Sheet 00)
- Tree Plans Suffolk Site (Sheet 01)
- Tree Plans Suffolk Site (Sheet 02)
- Tree Plans Suffolk Site (Sheet 03)
- Tree Plans Suffolk Site (Sheet 04)
- Tree Plans Suffolk Site (Sheet 05)
- Tree Plans Suffolk Site (Sheet 06)
- Tree Plans Suffolk Site (Sheet 07)
- Tree Plans Suffolk Site (Sheet 08)
- Tree Plans Suffolk Site (Sheet 09)

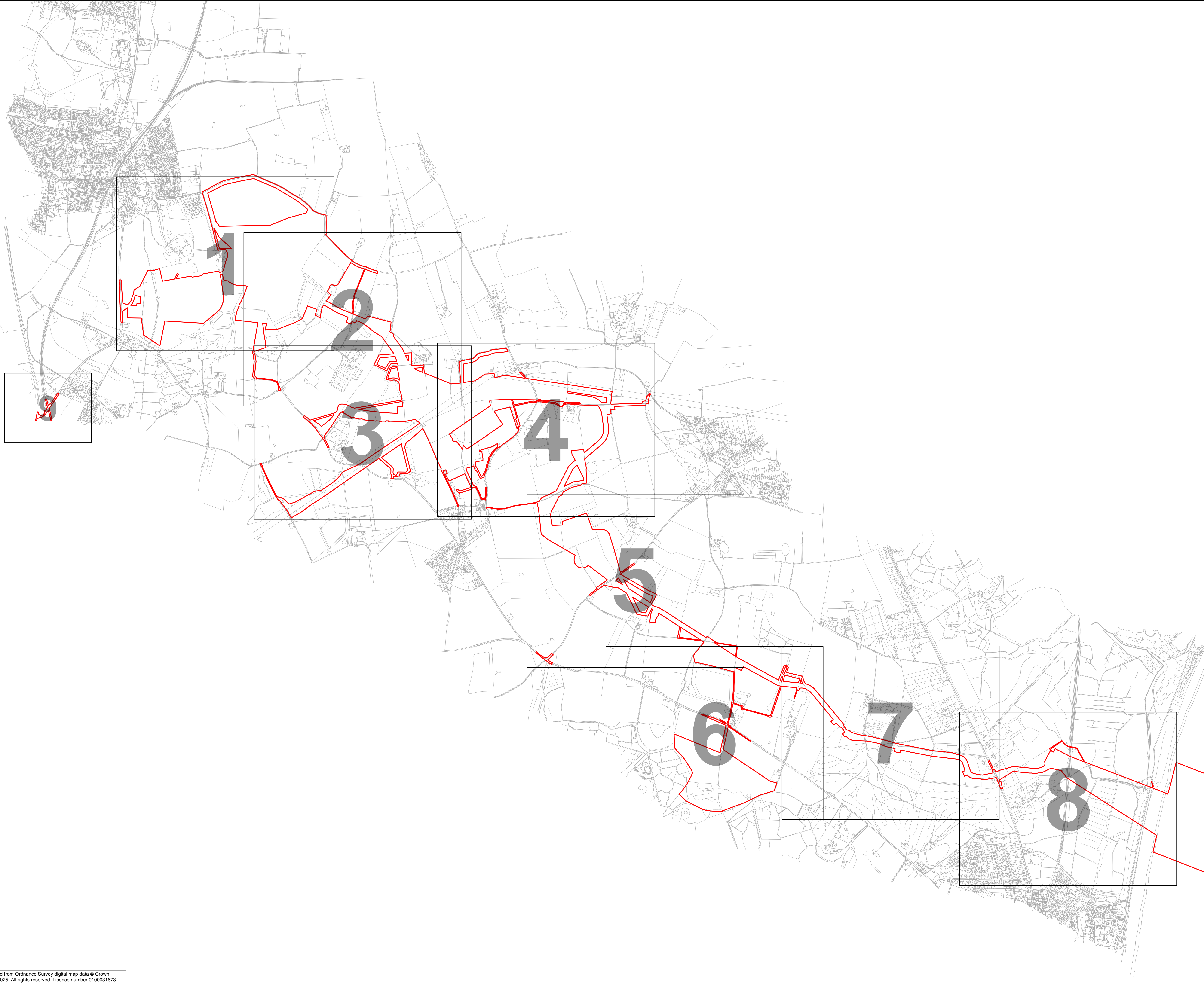

AECOM

PROJECT

Sea Link (Suffolk)

CLIENT

National Grid

CONSULTANT

AECOM
Mid Point, Alencon Link,
Basingstoke, Hants,
RG21 7PP
Tel +44 (0) 1256 310 200
www.aecom.com

GENERAL NOTES

1. TREE CATEGORIES AS DEFINED BY BS 5837:2012
2. TREE LOCATIONS ARE BASED ON THE OS MAPPING, AERIAL IMAGERY, AND GPS CO-ORDINATES FROM ON SITE WALKOVER.
3. * INDICATES A TREE / GROUP WHOSE POSITION IS APPROXIMATE AS BASED UPON AERIAL PHOTOGRAPHY AND ON SITE OBSERVATIONS.
4. PLANS SHOULD BE READ IN CONJUNCTION WITH THE AECOM ARBORICULTURAL REPORT.
5. THE ORIGINAL OF THIS DRAWING WAS PRODUCED IN COLOUR - A MONOCHROME COPY SHOULD NOT BE RELIED UPON.
6. DRAWING REFERENCES:
 - LPA Searches.dwg
 - OSMM_Lines.dwg
 - RevC_Draft_Order_Limits.dwg

KEY PLAN

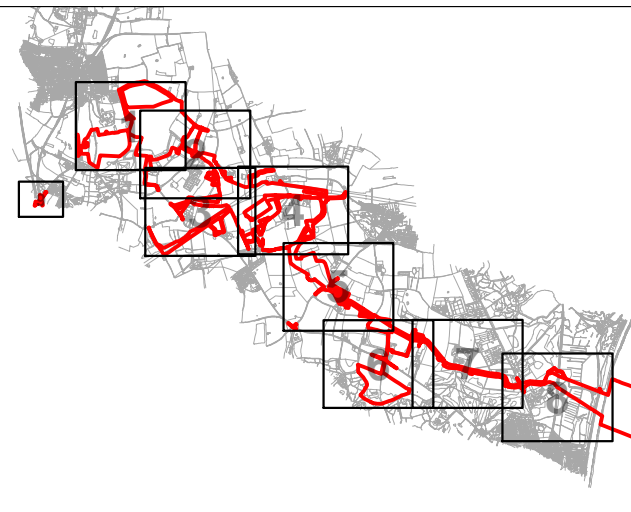

KEY

- ORDER LIMITS**
 - A CATEGORY TREE, GROUP, HEDGE, OR WOODLAND** (HIGH QUALITY & VALUE)
 - B CATEGORY TREE, GROUP, HEDGE, OR WOODLAND** (MODERATE QUALITY & VALUE)
 - C CATEGORY TREE, GROUP, HEDGE, OR WOODLAND** (LOW QUALITY & VALUE)
 - U CATEGORY TREE, GROUP, HEDGE, OR WOODLAND** (UNSATURABLE FOR RETENTION)
 - ROOT PROTECTION AREAS (RPA)** (AS DEFINED BY BS 5837:2012)
- VETERAN TREE MARKER** (INDICATES POSITION OF TREE OF VETERAN STATUS)
- ANCIENT TREE MARKER** (INDICATES POSITION OF TREE OF ANCIENT STATUS)
- ANCIENT WOODLAND (W/15m BUFFER ZONE)** (AREA CLASSIFIED AS AN ANCIENT WOODLAND)
- PRIORITY HABITAT** (CONSIDERED AN AREA OF PRIORITY HABITAT)
- SSSI AREA** (AREA CONTAINING SITE OF SPECIAL SCIENTIFIC INTEREST)
- NATURE RESERVE** (AREA CLASSIFIED AS A LOCAL OR NATIONAL NATURE RESERVE)
- TREE PRESERVATION ORDER** (AREA COVERED BY A TREE PRESERVATION ORDER (TPO))

ISSUE/REVISION

A V2	14.11.25	REVISION A (VERSION 2 CHANGE REQUEST)
P06	08.01.25	TREE FEATURE AMENDMENTS
P04	12.12.24	SECOND ISSUE
P03	22.11.24	UPDATED RLB
P02	30.10.24	SURVEY UPDATE
P01	16.08.24	FIRST ISSUE
I/R	DATE	DESCRIPTION

DRAWING STATUS

ISSUE

PROJECT NUMBER

60664038

SHEET TITLE

TREE PLANS
SUFFOLK SITE
(SHEET 00)

SHEET NUMBER

60664038-ACM-XX-SK-AB-TCP-000 A VER 2

REV.

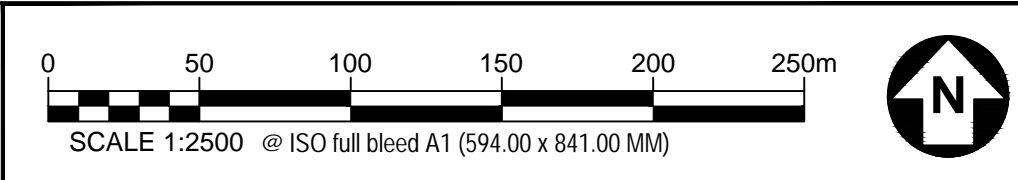
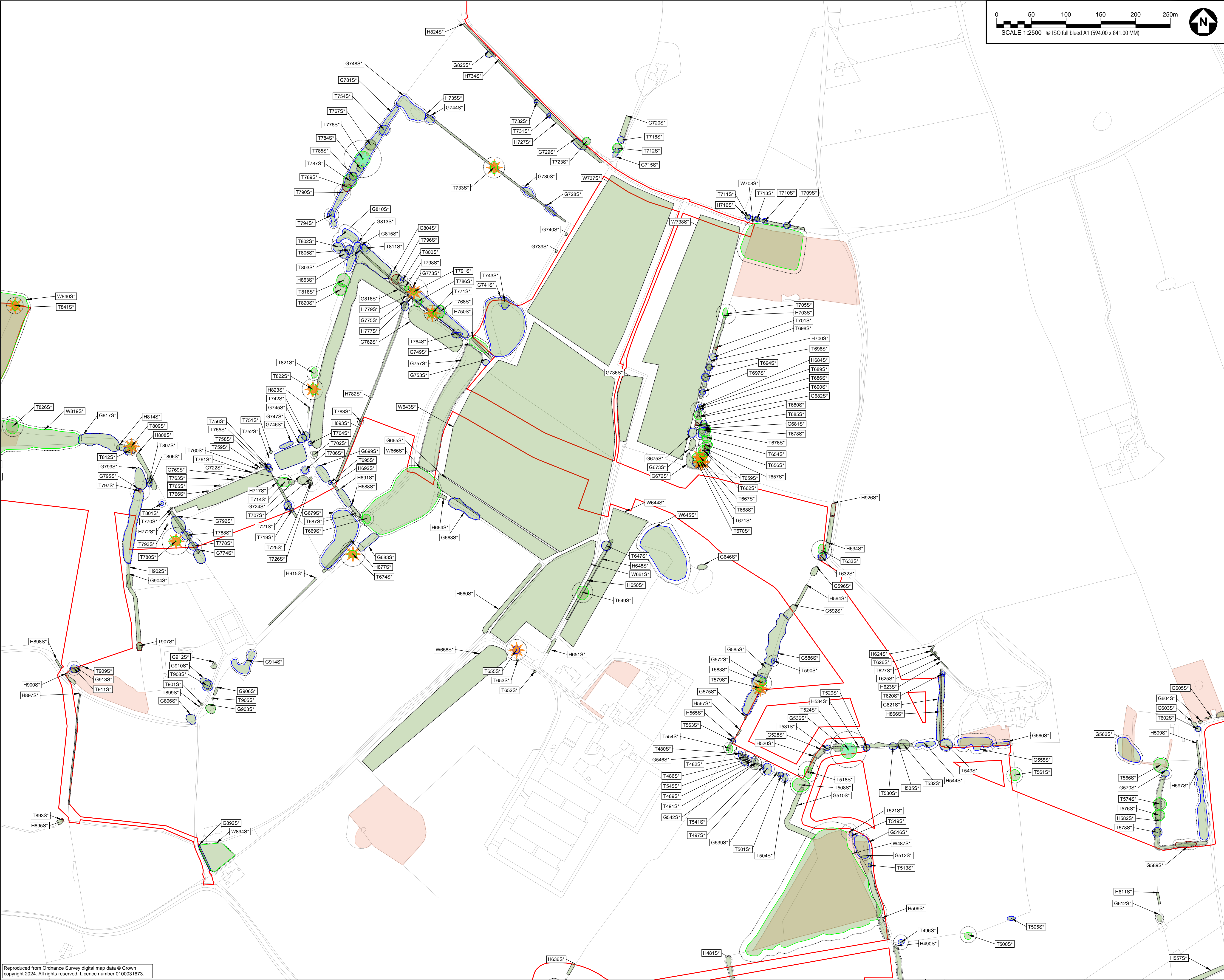

PROJECT

Sea Link (Suffolk)

CLIENT

National Grid

CONSULTANT

AECOM
Mid Point, Alencon Link,
Basingstoke, Hants,
RG21 7PP
Tel +44 (0) 1256 310 200
www.aecom.com

GENERAL NOTES

1. TREE CATEGORIES AS DEFINED BY BS 5837:2012
2. TREE LOCATIONS ARE BASED ON THE OS MAPPING, AERIAL IMAGERY, AND GPS CO-ORDINATES FROM ON SITE WALKOVER.
3. * INDICATES A TREE / GROUP WHOSE POSITION IS APPROXIMATE AS BASED UPON AERIAL PHOTOGRAPHY AND ON SITE OBSERVATIONS.
4. PLANS SHOULD BE READ IN CONJUNCTION WITH THE AECOM ARBORICULTURAL REPORT.
5. THE ORIGINAL OF THIS DRAWING WAS PRODUCED IN COLOUR - A MONOCHROME COPY SHOULD NOT BE RELIED UPON.
6. DRAWING REFERENCES:
 - LPA Searches.dwg
 - OSMML Lines.dwg
 - RevC_Draft_Order_Limits.dwg

KEY PLAN

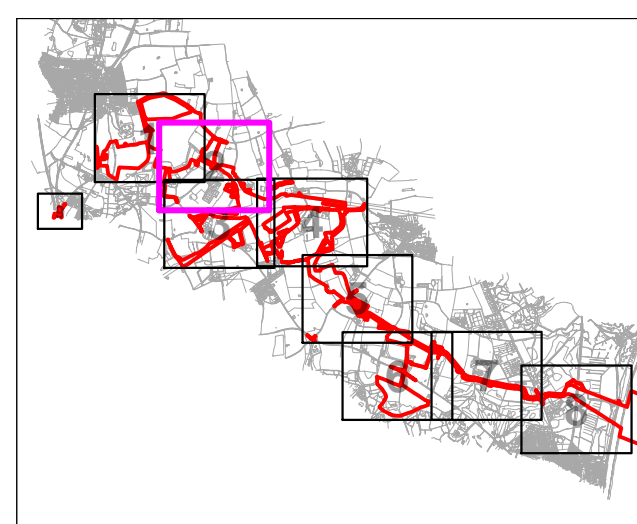

KEY

- ORDER LIMITS**
 - A CATEGORY TREE, GROUP, HEDGE, OR WOODLAND** (HIGH QUALITY & VALUE)
 - B CATEGORY TREE, GROUP, HEDGE, OR WOODLAND** (MODERATE QUALITY & VALUE)
 - C CATEGORY TREE, GROUP, HEDGE, OR WOODLAND** (LOW QUALITY & VALUE)
 - U CATEGORY TREE, GROUP, HEDGE, OR WOODLAND** (UNSUITABLE FOR RETENTION)
 - ROOT PROTECTION AREAS (RPA)** (AS DEFINED BY BS 5837:2012)
- VETERAN TREE MARKER** (INDICATES POSITION OF TREE OF VETERAN STATUS)
- ANCIENT TREE MARKER** (INDICATES POSITION OF TREE OF ANCIENT STATUS)
- ANCIENT WOODLAND (W15m BUFFER ZONE)** (AREA CLASSIFIED AS AN ANCIENT WOODLAND)
- PRIORITY HABITAT** (CONSIDERED AN AREA OF PRIORITY HABITAT)
- SSSI AREA** (AREA CONTAINING SITE OF SPECIAL SCIENTIFIC INTEREST)
- NATURE RESERVE** (AREA CLASSIFIED AS A LOCAL OR NATIONAL NATURE RESERVE)
- TREE PRESERVATION ORDER** (AREA COVERED BY A TREE PRESERVATION ORDER (TPO))

ISSUE/REVISION

REV	DATE	DESCRIPTION
A V2	14.11.25	REVISION A (VERSION 2 CHANGE REQUEST)
P05	08.01.25	TREE FEATURE AMENDMENTS
P04	12.12.24	SECOND ISSUE
P03	22.11.24	UPDATED RLB
P02	30.10.24	SURVEY UPDATE
P01	16.08.24	FIRST ISSUE
I/R	DATE	DESCRIPTION

DRAWING STATUS

ISSUE

PROJECT NUMBER

60664038

SHEET TITLE

TREE PLANS
SUFFOLK SITE
(SHEET 02)

SHEET NUMBER

60664038-ACM-XX-SK-AB-TCP-002

REV.

A VER 2

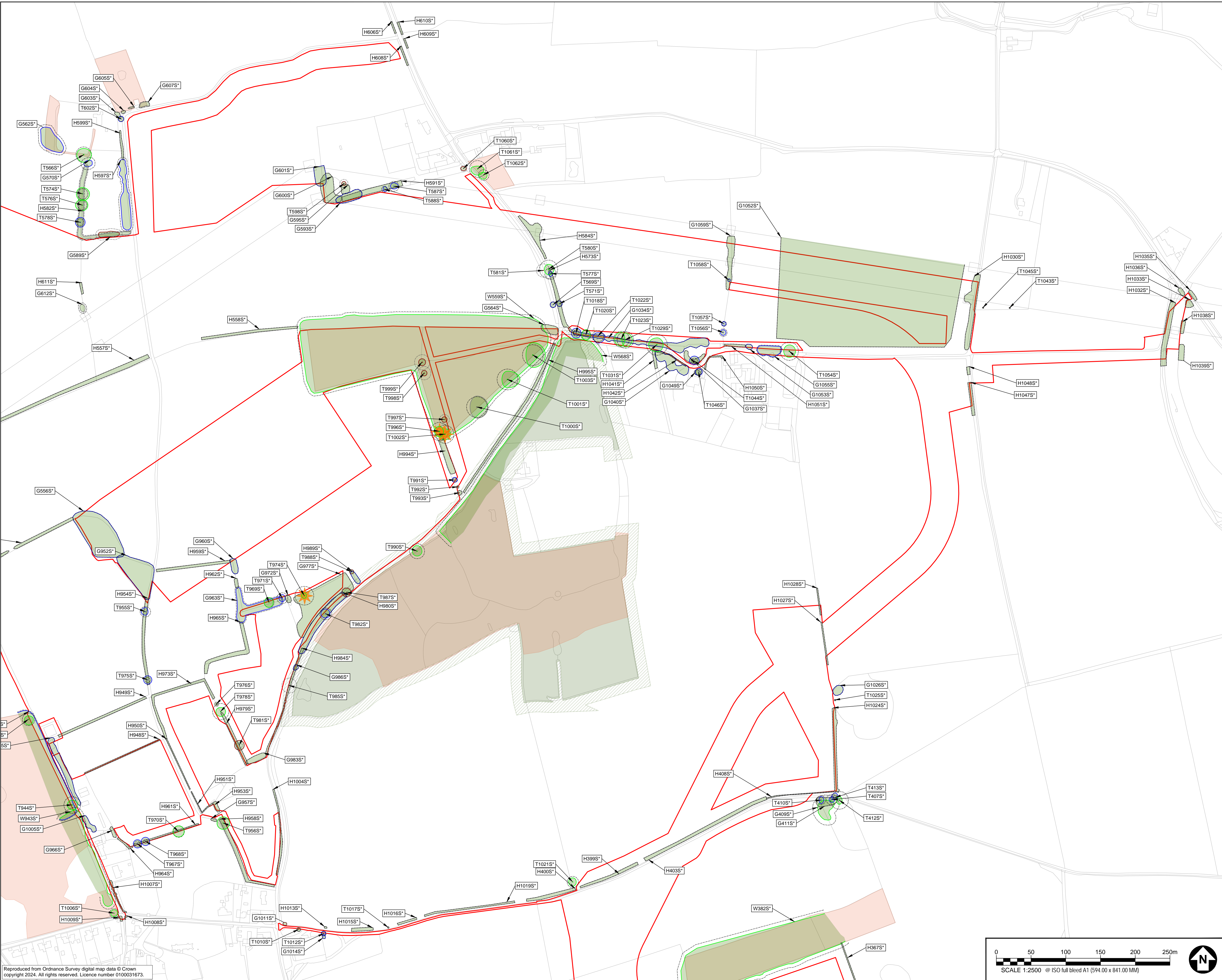

Reproduced from Ordnance Survey digital map data © Crown copyright 2024. All rights reserved. Licence number 0100031673.



PROJECT

Sea Link (Suffolk)

CLIENT

National Grid

CONSULTANT

AECOM
Mid Point, Alencon Link,
Basingstoke, Hants,
RG21 7PP
Tel +44 (0) 1256 310 200
www.aecom.com

GENERAL NOTES

1. TREE CATEGORIES AS DEFINED BY BS 5837:2012
2. TREE LOCATIONS ARE BASED ON THE OS MAPPING, AERIAL IMAGERY, AND GPS CO-ORDINATES FROM ON SITE WALKOVER.
3. * INDICATES A TREE / GROUP WHOSE POSITION IS APPROXIMATE AS BASED UPON AERIAL PHOTOGRAPHY AND ON SITE OBSERVATIONS.
4. PLANS SHOULD BE READ IN CONJUNCTION WITH THE AECOM ARBORICULTURAL REPORT.
5. THE ORIGINAL OF THIS DRAWING WAS PRODUCED IN COLOUR - A MONOCHROME COPY SHOULD NOT BE RELIED UPON.
6. DRAWING REFERENCES:
LPA Searches.dwg
OSM_Lines.dwg
RevC_Draft_Order_Limits.dwg

KEY PLAN

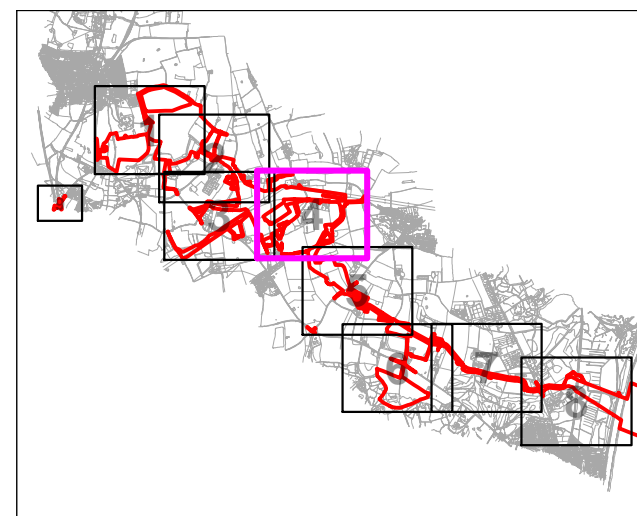

KEY

- ORDER LIMITS**
- A CATEGORY TREE, GROUP, HEDGE, OR WOODLAND**
(HIGH QUALITY & VALUE)
- B CATEGORY TREE, GROUP, HEDGE, OR WOODLAND**
(MODERATE QUALITY & VALUE)
- C CATEGORY TREE, GROUP, HEDGE, OR WOODLAND**
(LOW QUALITY & VALUE)
- U CATEGORY TREE, GROUP, HEDGE, OR WOODLAND**
(UNSUITABLE FOR RETENTION)
- ROOT PROTECTION AREAS (RPA)**
(AS DEFINED BY BS 5837:2012)
- VETERAN TREE MARKER**
(INDICATES POSITION OF TREE OF VETERAN STATUS)
- ANCIENT TREE MARKER**
(INDICATES POSITION OF TREE OF ANCIENT STATUS)
- ANCIENT WOODLAND (W15m BUFFER ZONE)**
(AREA CLASSIFIED AS AN ANCIENT WOODLAND)
- PRIORITY HABITAT**
(CONSIDERED AN AREA OF PRIORITY HABITAT)
- SSSI AREA**
(AREA CONTAINING SITE OF SPECIAL SCIENTIFIC INTEREST)
- NATURE RESERVE**
(AREA CLASSIFIED AS A LOCAL OR NATIONAL NATURE RESERVE)
- TREE PRESERVATION ORDER**
(AREA COVERED BY A TREE PRESERVATION ORDER (TPO))

ISSUE/REVISION

A V2	14.11.25	REVISION A (VERSION 2 CHANGE REQUEST)
P06	08.01.25	TREE FEATURE AMENDMENTS
P04	12.12.24	SECOND ISSUE
P03	22.11.24	UPDATED RLB
P02	30.10.24	SURVEY UPDATE
P01	16.08.24	FIRST ISSUE
I/R	DATE	DESCRIPTION

DRAWING STATUS

ISSUE

PROJECT NUMBER

60664038

SHEET TITLE

TREE PLANS
SUFFOLK SITE
(SHEET 04)

SHEET NUMBER

60664038-ACM-XX-SK-AB-TCP-004 A VER 2

REV.

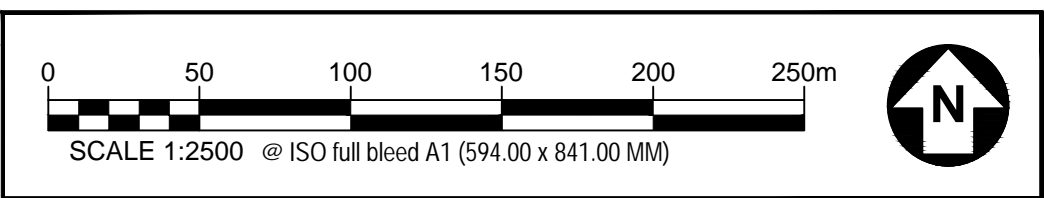
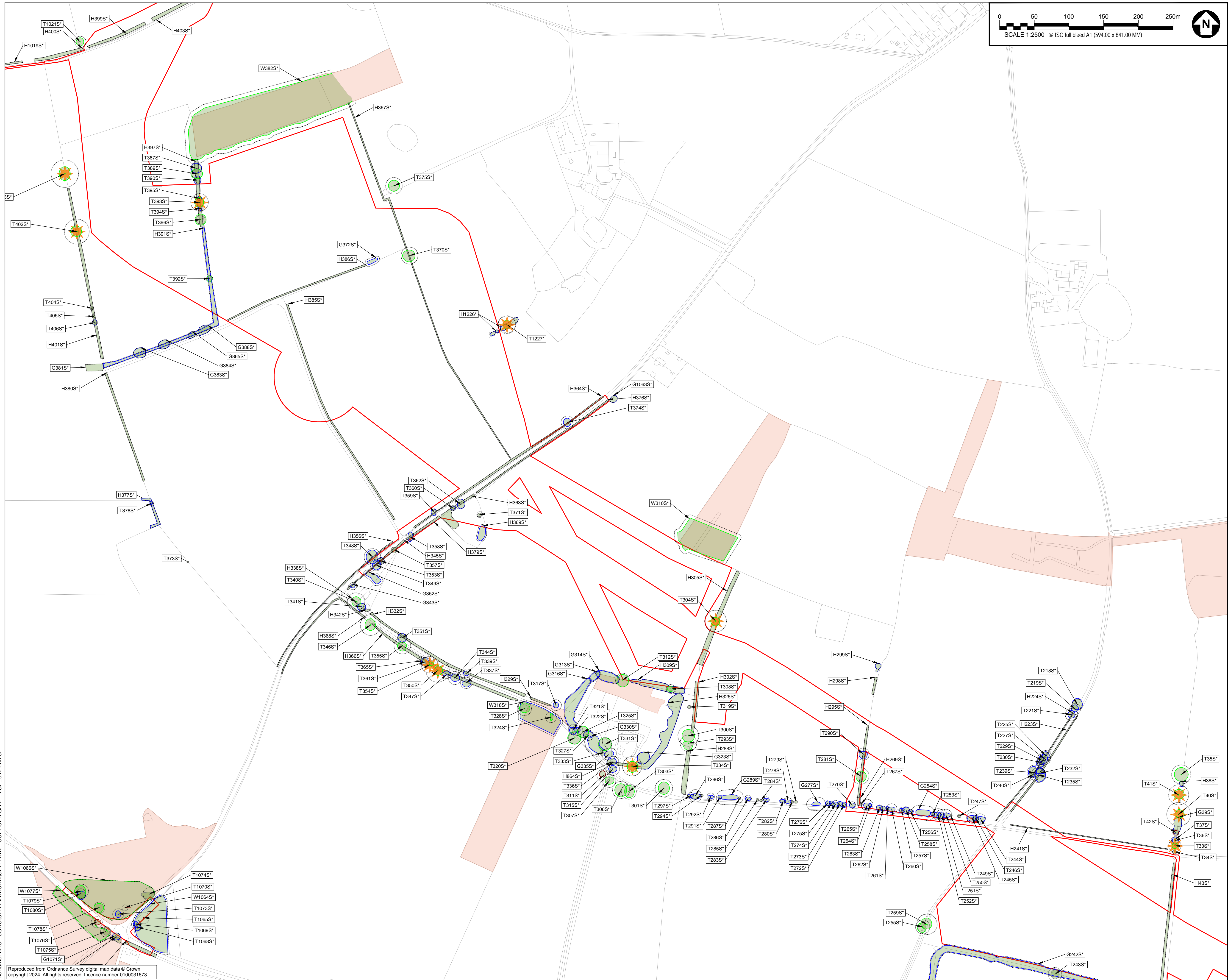

AECOM

PROJECT

Sea Link (Suffolk)

CLIENT

National Grid

CONSULTANT

AECOM
Mid Point, Alencon Link,
Basingstoke, Hants,
RG21 7PP
Tel +44 (0) 1256 310 200
www.aecom.com

GENERAL NOTES

2. TREE CATEGORIES AS DEFINED BY BS 5837:2012
3. TREE LOCATIONS ARE BASED ON THE OS MAPPING, AERIAL IMAGERY
AND GPS CO-ORDINATES FROM ON SITE WALKOVER.
3.3 * INDICATES A TREE / GROUP WHOSE POSITION IS APPROXIMATE AS
BASED UPON AERIAL PHOTOGRAPHY AND ON SITE OBSERVATIONS.
4. PLANS SHOULD BE READ IN CONJUNCTION WITH THE AECOM
ARBORESCULTURAL REPORT.
5. THE ORDER OF THE DRAWING WAS PRODUCED IN COLOUR - A
MONOCHROME COPY SHOULD NOT BE RELIED UPON.
6. DRAWING REFERENCES:
LPA Searches.dwg
OSMM_Lines.dwg
RevC_Draft_Order Limits.dwg

KEY PLAN

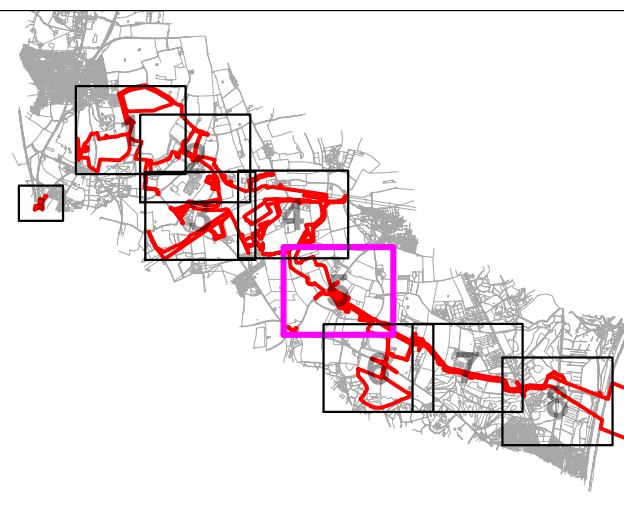

KEY

- ORDER LIMITS**
- A CATEGORY TREE, GROUP, HEDGE, OR WOODLAND**
(HIGH QUALITY & VALUE)
- B CATEGORY TREE, GROUP, HEDGE, OR WOODLAND**
(MODERATE QUALITY & VALUE)
- C CATEGORY TREE, GROUP, HEDGE, OR WOODLAND**
(LOW QUALITY & VALUE)
- U CATEGORY TREE, GROUP, HEDGE, OR WOODLAND**
(UNSATISFACTORY FOR RETENTION)
- ROOT PROTECTION AREAS (RPA)**
(AS DEFINED BY BS 3637:2012)
- VETERAN TREE MARKER**
(INDICATES POSITION OF TREE OF VETERAN STATUS)
- ANCIENT TREE MARKER**
(INDICATES POSITION OF TREE OF ANCIENT STATUS)
- ANCIENT WOODLAND (W/15m BUFFER ZONE)**
(AREA CLASSIFIED AS AN ANCIENT WOODLAND)
- PRIORITY HABITAT**
(CONSIDERED AN AREA OF PRIORITY HABITAT)
- SSSI AREA**
(AREA CONTAINING SITE OF SPECIAL SCIENTIFIC INTEREST)
- NATURE RESERVE**
(AREA CLASSIFIED AS A LOCAL OR NATIONAL NATURE RESERVE)
- TREE PRESERVATION ORDER**
(AREA COVERED BY A TREE PRESERVATION ORDER (TPO))

ISSUE/REVISION

A V2	14.11.25	REVISION A (VERSION 2 CHANGE REQUEST)
P05	08.01.25	TREE FEATURE AMENDMENTS
P04	12.12.24	SECOND ISSUE
P03	22.11.24	UPDATED RLB
P02	30.10.24	SURVEY UPDATE
P01	16.08.24	FIRST ISSUE
I/R	DATE	DESCRIPTION

DRAWING STATUS

ISSUE

PROJECT NUMBER

60664038

SHEET TITLE

TREE PLANS
SUFFOLK SITE
(SHEET 05)

SHEET NUMBER

60664038-ACM-XX-SK-AB-TCP-005 A VER 2

REV

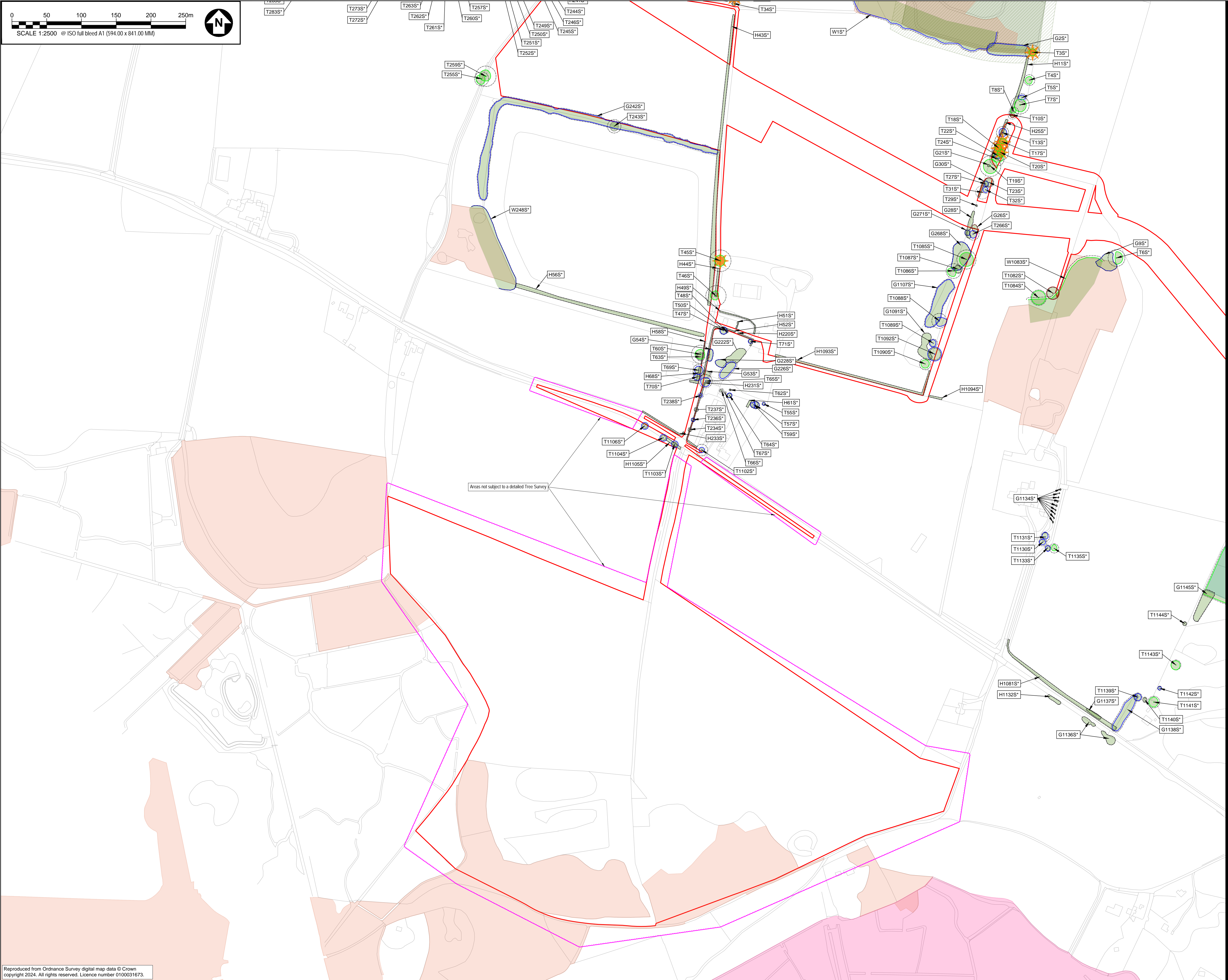

PROJECT

Sea Link (Suffolk)

CLIENT

National Grid

CONSULTANT

AECOM
Mid Point, Alencon Link,
Basingstoke, Hants,
RG21 7PP
Tel +44 (0) 1256 310 200
www.aecom.com

GENERAL NOTES

1. TREE CATEGORIES AS DEFINED BY BS 5837:2012
2. TREE LOCATIONS ARE BASED ON THE OS MAPPING, AERIAL IMAGERY, AND GPS CO-ORDINATES FROM ON SITE WALKOVER.
3. * INDICATES A TREE / GROUP WHOSE POSITION IS APPROXIMATE AS BASED UPON AERIAL PHOTOGRAPHY AND ON SITE OBSERVATIONS.
4. PLANS SHOULD BE READ IN CONJUNCTION WITH THE AECOM AGRICULTURAL REPORT.
5. THE ORIGINAL OF THIS DRAWING WAS PRODUCED IN COLOUR - A MONOCHROME COPY SHOULD NOT BE RELIED UPON.
6. DRAWING REFERENCES:
 - LPA Searches.dwg
 - OSM Lines.dwg
 - RevC_Draft_Order_Limits.dwg

KEY PLAN

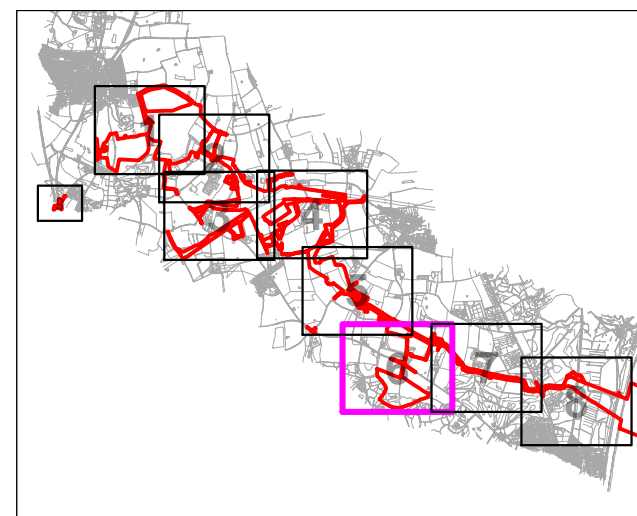

KEY

- ORDER LIMITS**
- A CATEGORY TREE, GROUP, HEDGE, OR WOODLAND**
(HIGH QUALITY & VALUE)
- B CATEGORY TREE, GROUP, HEDGE, OR WOODLAND**
(MODERATE QUALITY & VALUE)
- C CATEGORY TREE, GROUP, HEDGE, OR WOODLAND**
(LOW QUALITY & VALUE)
- U CATEGORY TREE, GROUP, HEDGE, OR WOODLAND**
(UNSUITABLE FOR RETENTION)
- ROOT PROTECTION AREAS (RPA)**
(AS DEFINED BY BS 5837:2012)
- VETERAN TREE MARKER**
(INDICATES POSITION OF TREE OF VETERAN STATUS)
- ANCIENT TREE MARKER**
(INDICATES POSITION OF TREE OF ANCIENT STATUS)
- ANCIENT WOODLAND (W15m BUFFER ZONE)**
(AREA CLASSIFIED AS AN ANCIENT WOODLAND)
- PRIORITY HABITAT**
(CONSIDERED AN AREA OF PRIORITY HABITAT)
- SSSI AREA**
(AREA CONTAINING SITE OF SPECIAL SCIENTIFIC INTEREST)
- NATURE RESERVE**
(AREA CLASSIFIED AS A LOCAL OR NATIONAL NATURE RESERVE)
- TREE PRESERVATION ORDER**
(AREA COVERED BY A TREE PRESERVATION ORDER (TPO))

ISSUE/REVISION

A V2	14.11.25	REVISION A (VERSION 2 CHANGE REQUEST)
P06	08.01.25	TREE FEATURE AMENDMENTS
P04	12.12.24	SECOND ISSUE
P03	22.11.24	UPDATED RLB
P02	30.10.24	SURVEY UPDATE
P01	16.08.24	FIRST ISSUE
I/R	DATE	DESCRIPTION

DRAWING STATUS

ISSUE

PROJECT NUMBER

60664038

SHEET TITLE

TREE PLANS
SUFFOLK SITE
(SHEET 06)

SHEET NUMBER

60664038-ACM-XX-SK-AB-TCP-006 A VER 2

REV.

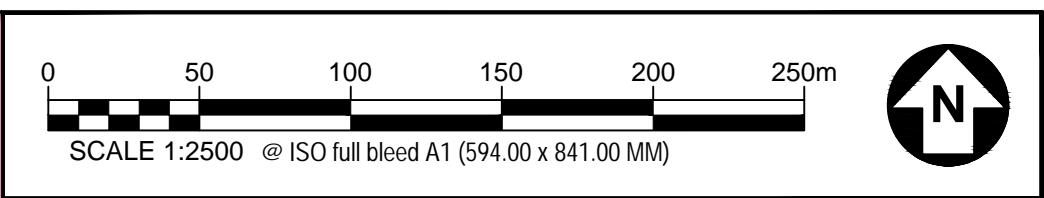
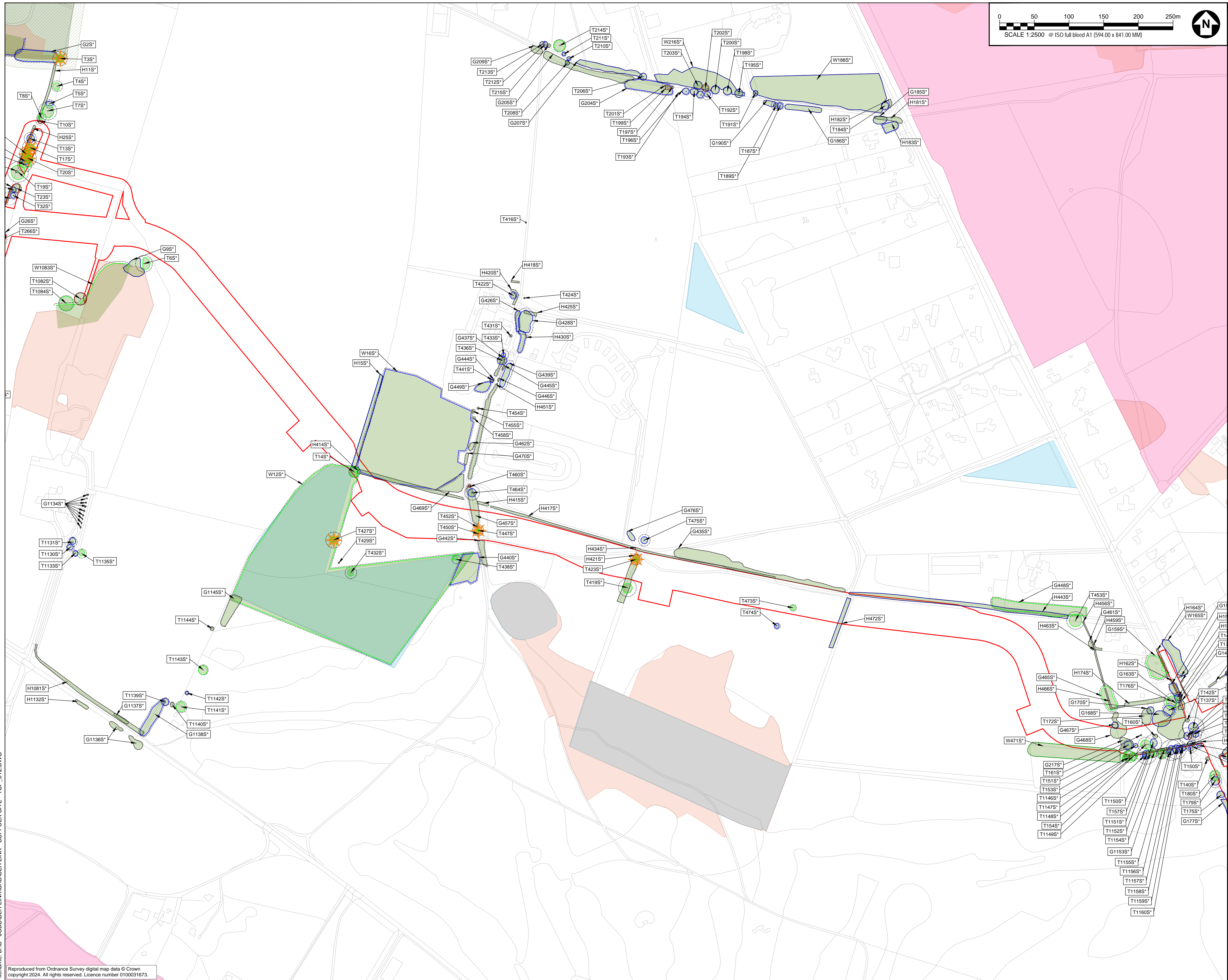
**AECOM**

PROJECT

Sea Link (Suffolk)

CLIENT

National Grid

CONSULTANT

AECOM
Mid Point, Alencon Link,
Basingstoke, Hants,
RG21 7PP
Tel +44 (0) 1256 310 200
www.aecom.com

GENERAL NOTES

2. TREE CATEGORIES AS DEFINED BY BS 5837: 2012
3. TREE LOCATIONS ARE BASED ON THE OS MAPPING, AERIAL IMAGERY,
AND GPS CO-ORDINATES FROM ON SITE WALKOVER.
3.1 INDICATES A TREE / GROUP WHOSE POSITION IS APPROXIMATE AS
BASED UPON AERIAL PHOTOGRAPHY AND ON SITE OBSERVATIONS.
3.2 PLANS SHOULD BE READ IN CONJUNCTION WITH THE AECOM
ARBORESCULTURAL REPORT.
3.3 THE ORDER OF THE DRAWING WAS PRODUCED IN COLOUR - A
MONOCHROME COPY SHOULD NOT BE RELIED UPON.
6. DRAWING REFERENCES:
LPA Searches.dwg
OSMM_Lines.dwg
RevC_Draft_Order Limits.dwg

KEY PLAN

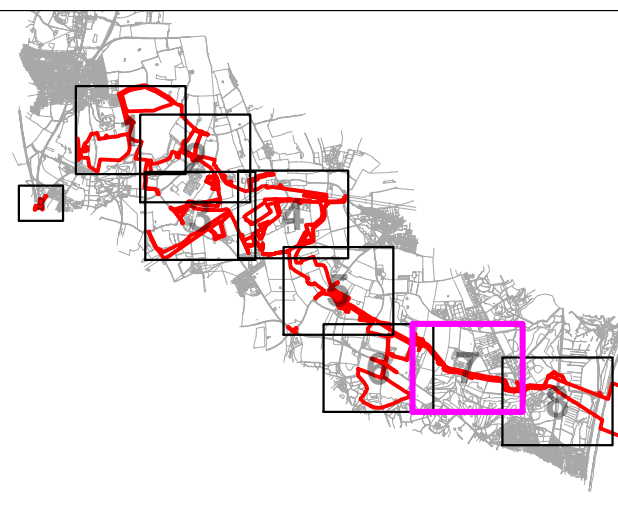

KEY

- ORDER LIMITS**
- A CATEGORY TREE, GROUP, HEDGE, OR WOODLAND**
(HIGH QUALITY & VALUE)
 - B CATEGORY TREE, GROUP, HEDGE, OR WOODLAND**
(MODERATE QUALITY & VALUE)
 - C CATEGORY TREE, GROUP, HEDGE, OR WOODLAND**
(LOW QUALITY & VALUE)
 - U CATEGORY TREE, GROUP, HEDGE, OR WOODLAND**
(UNSUITABLE FOR RETENTION)
 - ROOT PROTECTION AREAS (RPA)**
(AS DERIVED BY SCS 06/37-2012)
 - VETERAN TREE MARKER**
(INDICATES POSITION OF TREE OF VETERAN STATUS)
 - ANCIENT TREE MARKER**
(INDICATES POSITION OF TREE OF ANCIENT STATUS)
 - ANCIENT WOODLAND (W/15m BUFFER ZONE)**
(AREA CLASSIFIED AS AN ANCIENT WOODLAND)
 - PRIORITY HABITAT**
(ECODIVERSE AND/OR PRIORITY HABITAT)
 - SSSI AREA**
(AREA CONTAINING SITE OF SPECIAL SCIENTIFIC INTEREST)
 - NATURE RESERVE**
(AREA CLASSIFIED AS A LOCAL OR NATIONAL NATURE RESERVE)
 - TREE PRESERVATION ORDER**
(AREA COVERED BY A TREE PRESERVATION ORDER (TPO))

ISSUE/REVISION

A V2	14.11.25	REVISION A (VERSION 2 CHANGE REQUEST)
P05	08.01.25	TREE FEATURE AMENDMENTS
P04	12.12.24	SECOND ISSUE
P03	22.11.24	UPDATED RLB
P02	30.10.24	SURVEY UPDATE
P01	16.08.24	FIRST ISSUE
I/R	DATE	DESCRIPTION

DRAWING STATUS

ISSUE

PROJECT NUMBER

60664038

SHEET TITLE

TREE PLANS
SUFFOLK SITE
(SHEET 07)

SHEET NUMBER

60664038-ACM-XX-SK-AB-TCP-007 A VER 2

REV.

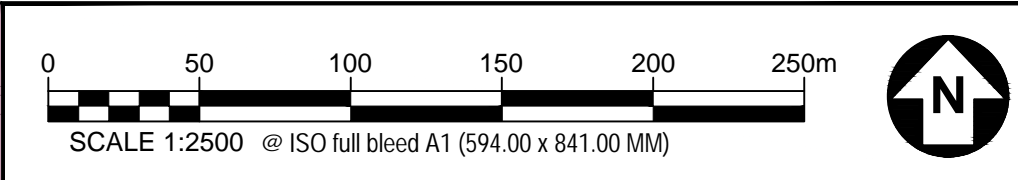
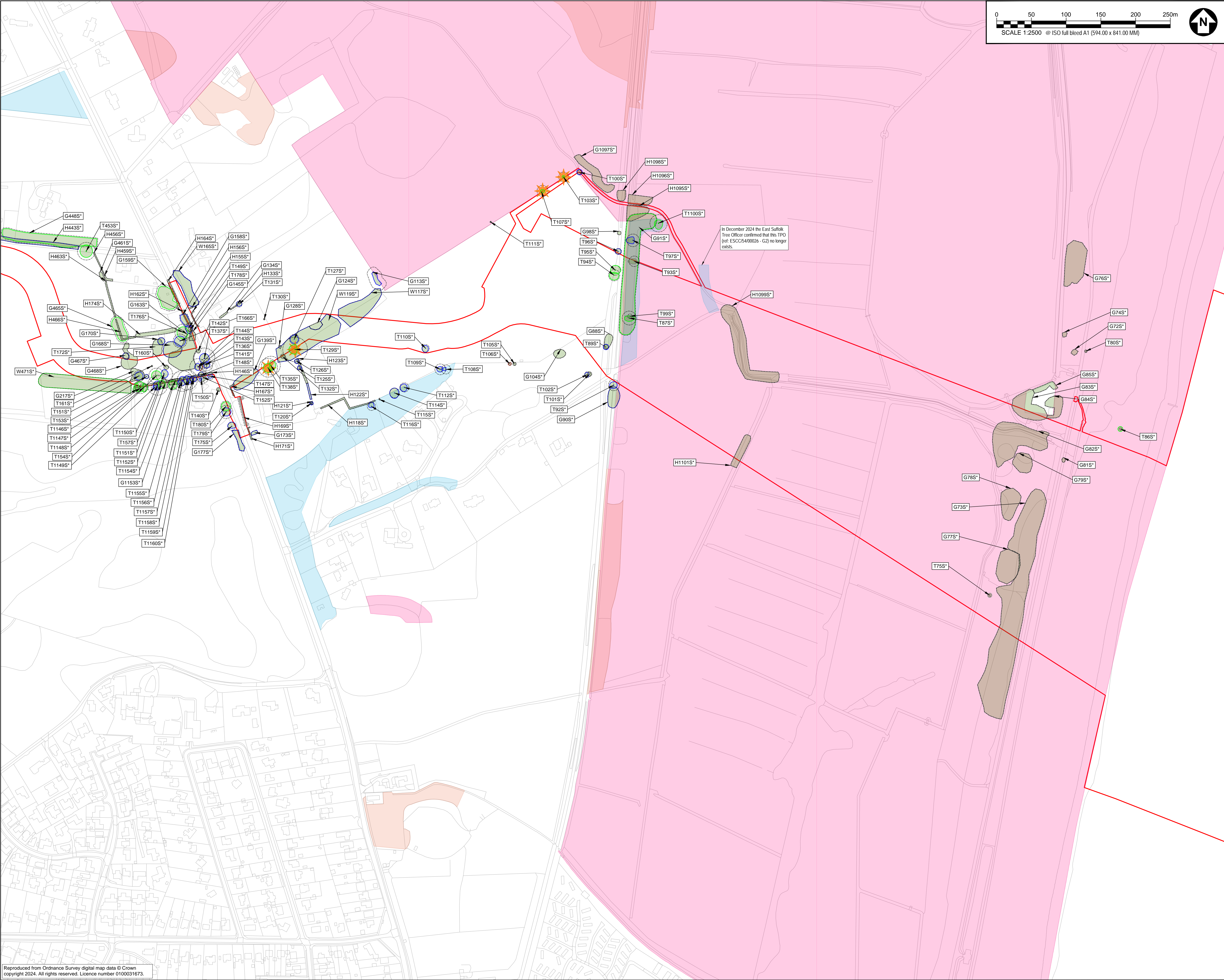

PROJECT

Sea Link (Suffolk)

CLIENT

National Grid

CONSULTANT

AECOM
Mid Point, Alencon Link,
Basingstoke, Hants,
RG21 7PP
Tel +44 (0) 1256 310 200
www.aecom.com

GENERAL NOTES

1. TREE CATEGORIES AS DEFINED BY BS 5837:2012
2. TREE LOCATIONS ARE BASED ON THE OS MAPPING, AERIAL IMAGERY, AND GPS CO-ORDINATES FROM ON SITE WALKOVER.
3. * INDICATES A TREE / GROUP WHOSE POSITION IS APPROXIMATE AS BASED UPON AERIAL PHOTOGRAPHY AND ON SITE OBSERVATIONS. ARBORICULTURAL REPORT.
4. PLANS SHOULD BE READ IN CONJUNCTION WITH THE AECOM ARBORICULTURAL REPORT.
5. THE ORIGINAL OF THIS DRAWING WAS PRODUCED IN COLOUR - A MONOCHROME COPY SHOULD NOT BE RELIED UPON.
6. DRAWING REFERENCES:
LPA Searches.dwg
OSMML Lines.dwg
RevC_Draft_Order_Limits.dwg

KEY PLAN

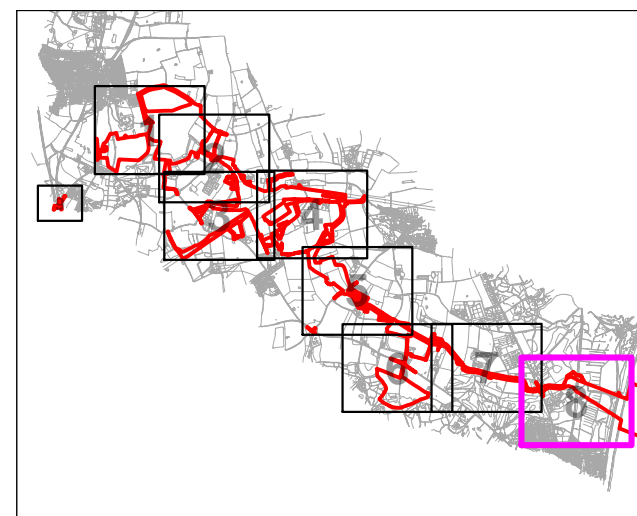

KEY

- ORDER LIMITS**
A CATEGORY TREE, GROUP, HEDGE, OR WOODLAND (HIGH QUALITY & VALUE)
B CATEGORY TREE, GROUP, HEDGE, OR WOODLAND (MODERATE QUALITY & VALUE)
C CATEGORY TREE, GROUP, HEDGE, OR WOODLAND (LOW QUALITY & VALUE)
U CATEGORY TREE, GROUP, HEDGE, OR WOODLAND (UNSUITABLE FOR RETENTION)
ROOT PROTECTION AREAS (RPA) (AS DEFINED BY BS 5837:2012)
- VETERAN TREE MARKER**
INDICATES POSITION OF TREE OF VETERAN STATUS
- ANCIENT TREE MARKER**
INDICATES POSITION OF TREE OF ANCIENT STATUS
- ANCIENT WOODLAND (W/15m BUFFER ZONE)**
(AREA CLASSIFIED AS AN ANCIENT WOODLAND)
- PRIORITY HABITAT**
(CONSIDERED AN AREA OF PRIORITY HABITAT)
- SSSI AREA**
(AREA CONTAINING SITE OF SPECIAL SCIENTIFIC INTEREST)
- NATURE RESERVE**
(AREA CLASSIFIED AS A LOCAL OR NATIONAL NATURE RESERVE)
- TREE PRESERVATION ORDER**
(AREA COVERED BY A TREE PRESERVATION ORDER (TPO))

ISSUE/REVISION

A V2	14.11.25	REVISION A (VERSION 2 CHANGE REQUEST)
P06	08.01.25	TREE FEATURE AMENDMENTS
P04	12.12.24	SECOND ISSUE
P03	22.11.24	UPDATED RLB
P02	30.10.24	SURVEY UPDATE
P01	16.08.24	FIRST ISSUE
I/R	DATE	DESCRIPTION

DRAWING STATUS

ISSUE

PROJECT NUMBER

60664038

SHEET TITLE

TREE PLANS
SUFFOLK SITE
(SHEET 08)

SHEET NUMBER

60664038-ACM-XX-SK-AB-TCP-008 A VER 2

REV.

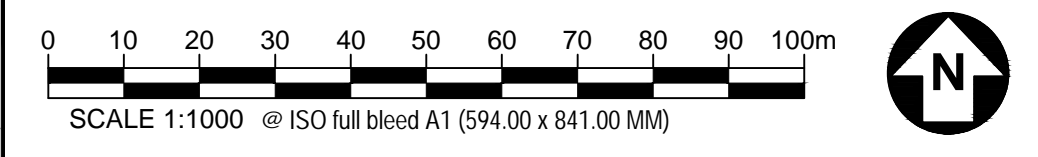
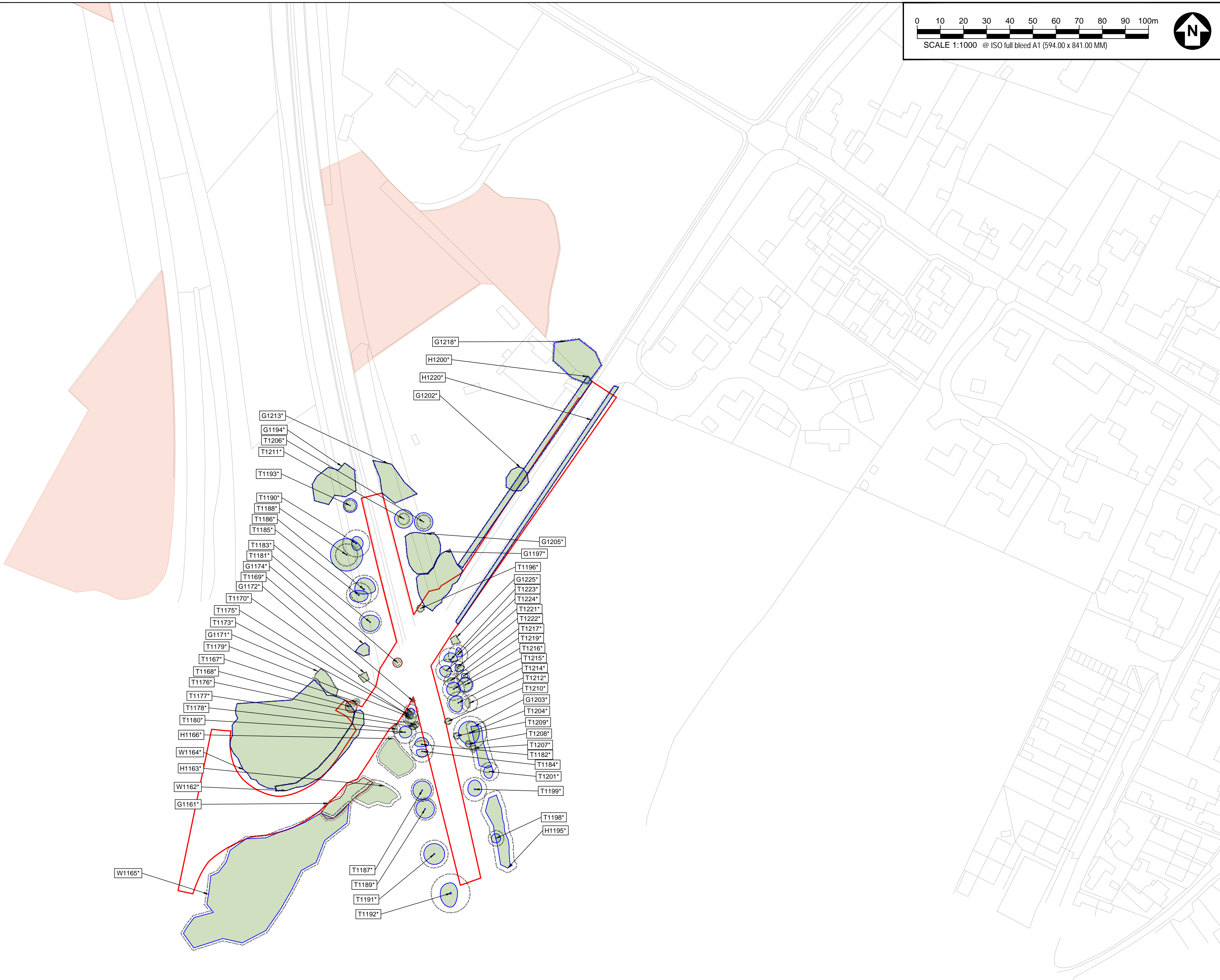

PROJECT

Sea Link (Suffolk)

CLIENT

National Grid

CONSULTANT

AECOM
Mid Point, Alencon Link,
Basingstoke, Hants,
RG21 7PP
Tel +44 (0) 1256 310 200
www.aecom.com

GENERAL NOTES

1. TREE CATEGORIES AS DEFINED BY BS 5837:2012
2. TREE LOCATIONS ARE BASED ON THE OS MAPPING, AERIAL IMAGERY, AND GPS CO-ORDINATES FROM ON SITE WALKOVER.
3. * INDICATES A TREE / GROUP WHOSE POSITION IS APPROXIMATE AS BASED UPON AERIAL PHOTOGRAPHY AND ON SITE OBSERVATIONS.
4. PLANS SHOULD BE READ IN CONJUNCTION WITH THE AECOM ARBORICULTURAL REPORT.
5. THE ORIGINAL OF THIS DRAWING WAS PRODUCED IN COLOUR - A MONOCHROME COPY SHOULD NOT BE RELIED UPON.
6. DRAWING REFERENCES:
 - LPA Searches.dwg
 - OSMML Lines.dwg
 - RevC_Draft_Order_Limits.dwg

KEY PLAN

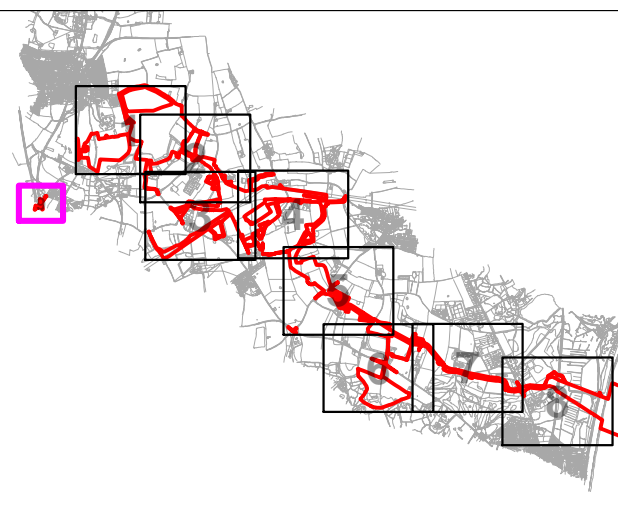

KEY

- ORDER LIMITS**
- A CATEGORY TREE, GROUP, HEDGE, OR WOODLAND**
(HIGH QUALITY & VALUE)
- B CATEGORY TREE, GROUP, HEDGE, OR WOODLAND**
(MODERATE QUALITY & VALUE)
- C CATEGORY TREE, GROUP, HEDGE, OR WOODLAND**
(LOW QUALITY & VALUE)
- U CATEGORY TREE, GROUP, HEDGE, OR WOODLAND**
(UNSATURABLE FOR RETENTION)
- ROOT PROTECTION AREAS (RPA)**
(AS DEFINED BY BS 5837:2012)
- VETERAN TREE MARKER**
(INDICATES POSITION OF TREE OF VETERAN STATUS)
- ANCIENT TREE MARKER**
(INDICATES POSITION OF TREE OF ANCIENT STATUS)
- ANCIENT WOODLAND (W15m BUFFER ZONE)**
(AREA CLASSIFIED AS AN ANCIENT WOODLAND)
- PRIORITY HABITAT**
(CONSIDERED AN AREA OF PRIORITY HABITAT)
- SSSI AREA**
(AREA CONTAINING SITE OF SPECIAL SCIENTIFIC INTEREST)
- NATURE RESERVE**
(AREA CLASSIFIED AS A LOCAL OR NATIONAL NATURE RESERVE)
- TREE PRESERVATION ORDER**
(AREA COVERED BY A TREE PRESERVATION ORDER (TPO))

ISSUE/REVISION

A V2	14.11.25	REVISION A (VERSION 2 CHANGE REQUEST)
P06	08.01.25	TREE FEATURE AMENDMENTS
P04	12.12.24	SECOND ISSUE
P03	22.11.24	UPDATED RLB
P02	30.10.24	SURVEY UPDATE
P01	16.08.24	FIRST ISSUE
I/R	DATE	DESCRIPTION

DRAWING STATUS

ISSUE

PROJECT NUMBER

60664038

SHEET TITLE

TREE PLANS
SUFFOLK SITE
(SHEET 09)

SHEET NUMBER

60664038-ACM-XX-SK-AB-TCP-009 A VER 2

REV.

National Grid plc
National Grid House,
Warwick Technology Park,
Gallows Hill, Warwick.
CV34 6DA United Kingdom

Registered in England and Wales
No. 4031152
nationalgrid.com